



## 16 Wilman Way, Salisbury, Wiltshire, SP2 8QS

\*\*\* VIEWINGS ON HOLD DUE TO HIGH DEMAND\*\*\*

- DETACHED FOUR BEDROOM FAMILY HOUSE
- EN-SUITE SHOWER ROOM
- SITTING ROOM DINING ROOM AND CONSERVATORY
- STUDY / OFFICE
- FITTED KITCHEN
- UTILITY ROOM
- DRIVE WAY PARKING FOR 2 CARS
- COUNCIL TAX BAND E
- EPC - C

**£1,500 PCM**

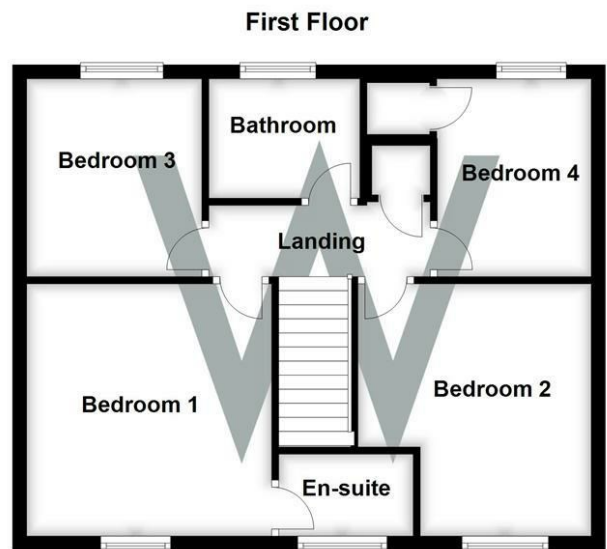
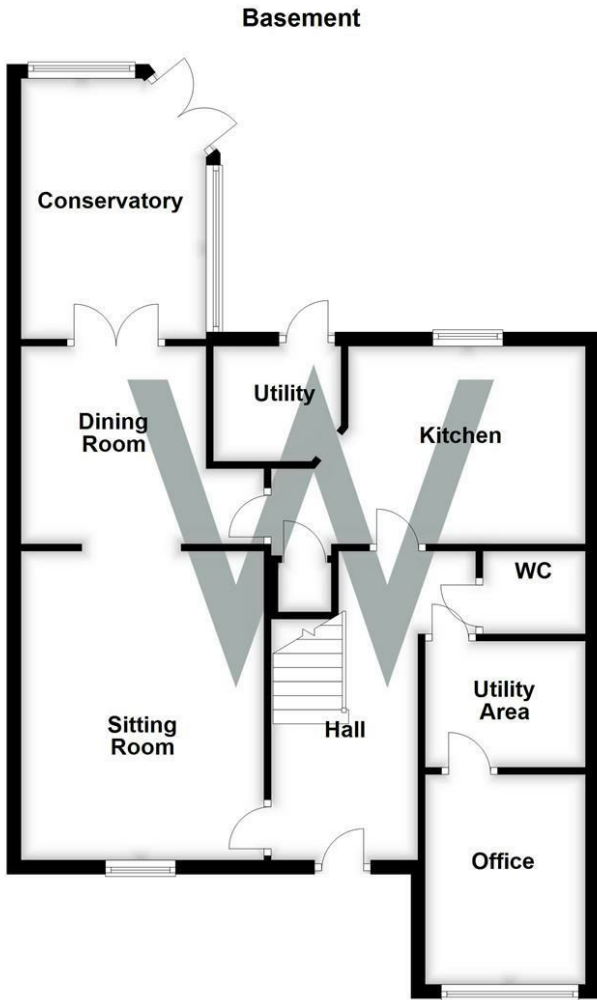

**WHITES**

Castle Chambers, 47 Castle Street, Salisbury,  
 Wiltshire, SP1 3SP  
 Tel: 01722 336422/Option 2  
 www.hwwhite.co.uk  
 email: lettings-management@hwwhites.co.uk

Energy Efficiency Rating		Current	Potential
Very energy efficient - lower running costs			
(92 plus) <b>A</b>			
(81-91) <b>B</b>			
(69-80) <b>C</b>			
(55-68) <b>D</b>			
(39-54) <b>E</b>			
(21-38) <b>F</b>			
(1-20) <b>G</b>			
Not energy efficient - higher running costs			
		<b>71</b>	<b>83</b>
<b>England &amp; Wales</b>		EU Directive 2002/91/EC	

Environmental Impact (CO <sub>2</sub> ) Rating		Current	Potential
Very environmentally friendly - lower CO <sub>2</sub> emissions			
(92 plus) <b>A</b>			
(81-91) <b>B</b>			
(69-80) <b>C</b>			
(55-68) <b>D</b>			
(39-54) <b>E</b>			
(21-38) <b>F</b>			
(1-20) <b>G</b>			
Not environmentally friendly - higher CO <sub>2</sub> emissions			
<b>England &amp; Wales</b>		EU Directive 2002/91/EC	